

THIS DOCUMENT CONTAINS INFORMATION PROPRIETARY TO GENESIS FILTRATION CORPORATION. ANY REPRODUCTION, DISCLOSURE, OR USE OF THIS DOCUMENT IN WHOLE OR IN PART IS EXPRESSLY PROHIBITED EXCEPT AS GENESIS FILTRATION CORPORATION MAY OTHERWISE AGREE TO IN WRITING.

FITTING END PER MS33514 - SEE TABLE -

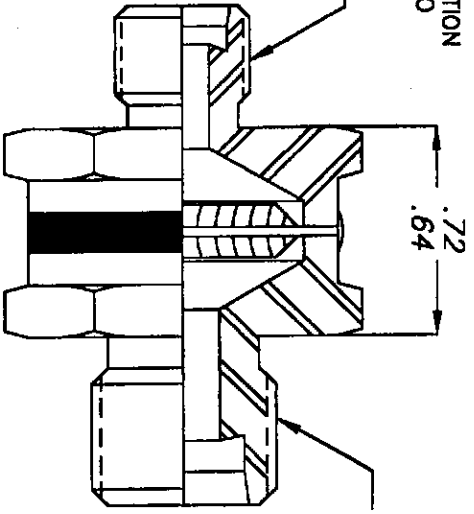

FITTING END PER MS33514 - SEE TABLE -

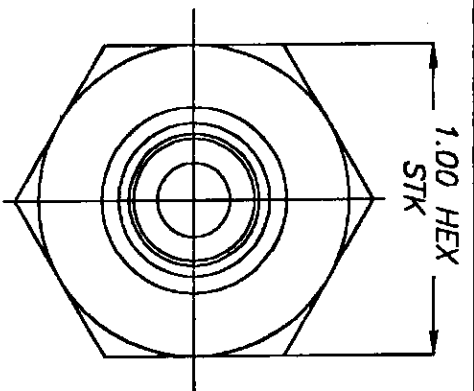

REVISIONS			
LTR	DESCRIPTION	DATE	APPROVED

9. PRESSURE DATA:
 OPERATING: 6000 PSIG
 PROOF: 9000 PSIG
 BURST: 13,500 PSIG
8. ELEMENT COLLAPSE PRESSURE: 50 PSID MIN
7. MATERIALS: AISI TYPE 300 SER. CRES.
6. EFFECTIVE FILTER AREA: 3.3 SQ. IN MIN.
5. CONSTRUCTION: TIG WELDED
4. FILTER MEDIA: STAINLESS STEEL WOVEN WIRE MESH.
3. SECOND DASH NUMBER SPECIFIES NOM. MICRON RATING.
2. SECOND DASH NUMBER SPECIFIES FITTING END SIZE.
1. FIRST DASH NUMBER SPECIFIES FITTING END SIZE.

-	1	2	3
TUBE NO	TUBE O.D.	TUBE NO	TUBE O.D.
-4	1/4	-4	1/4
-5	5/16	-5	5/16
-6	3/8	-6	3/8
-8	1/2	-8	1/2

-	1	2	3
TUBE NO	TUBE O.D.	TUBE NO	TUBE O.D.
-4	1/4	-4	1/4
-5	5/16	-5	5/16
-6	3/8	-6	3/8
-8	1/2	-8	1/2

-	1	2	3
NOM MIC RATING	NOM MIC RATING	NOM MIC RATING	NOM MIC RATING
-2	-5	-10	-20
-40	-70	-105	-105

ADDITIONAL SIZES AND OPTIONS AVAILABLE.

UNLESS OTHERWISE SPECIFIED		DO NOT SCALE THIS DWG. INTERPRET DWG PER IAW DOD-STD-1000 DIMS & TOLS. PER ANSI Y14.5		DFT BY:		DESIGN BY:		APPVD BY:		CUSTOMER NAME		CUSTOMER P/N		FINISH			
DIMENSIONS IN INCHES REMOVE ALL BURRS		MACHINE RADI .005/.015 R. BREAK ALL SHARP EDGES .002/.010 R.		SURFACE ROUGHNESS PER ANSI B46.1 100		MATERIAL NOTED		MATERIAL		FINISH		CUSTOMER NAME		CUSTOMER P/N			
DECIMALS .XX .XXX		FRAC		ANGLES		± .01 ± .005		± 1/64		± 1°		TITLE		REV			
<p>Genesis Filtration Inc. 9757 7th STREET, UNIT 804 Rancho Cucamonga, CA 91730</p>												SCALE		WEIGHT		SHEET OF	
<p>FLARELESS TUBE ASSY</p>												REV					